

CM-BGM-II-US Series CI Series

Install Instructions for:

CM52-BGM-II-US, CM52s-BGM-II-US, CM62-BGM-II-US, CM82-BGM-II-US
CI52, CI52s, and CI62

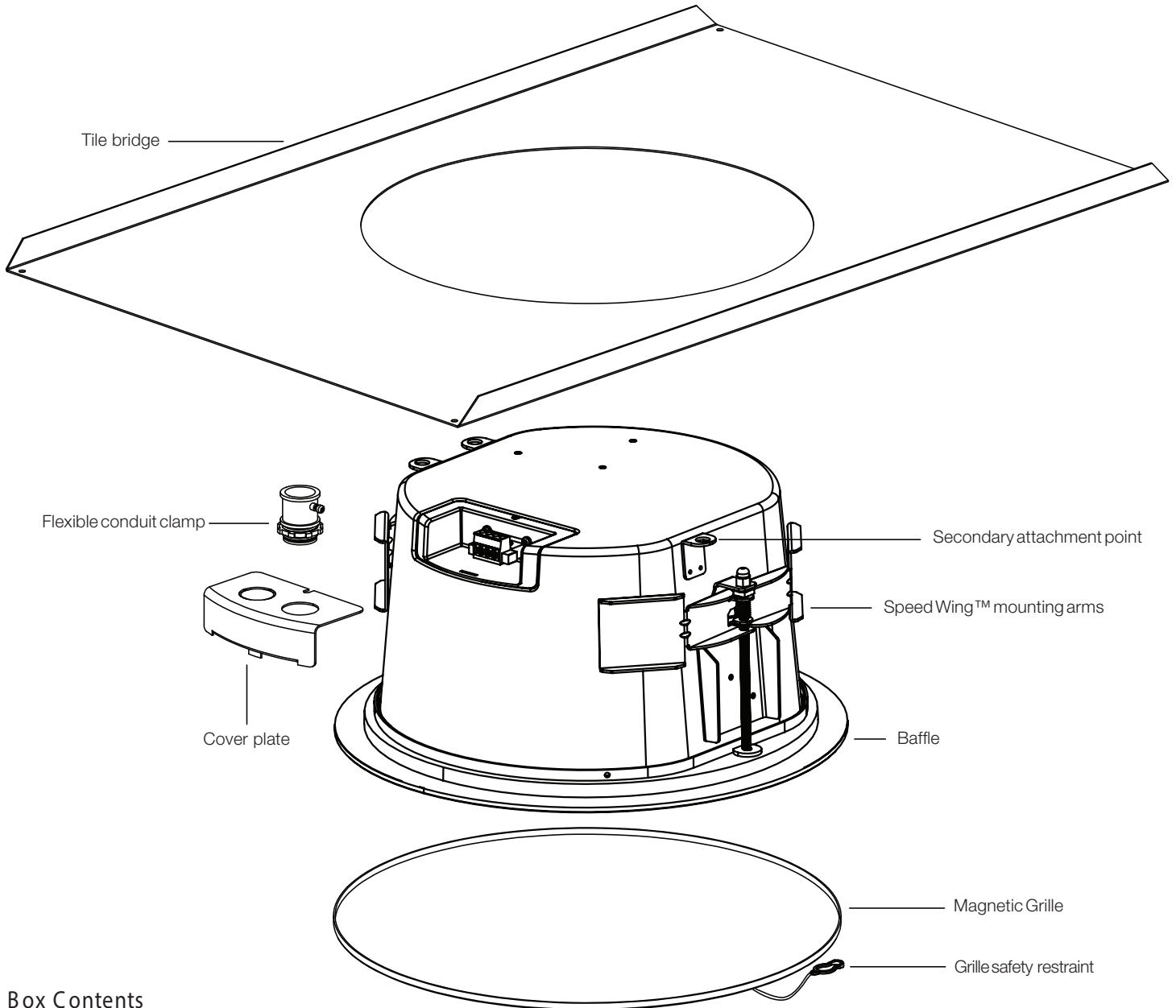

Box Contents

- 1 Speaker
- 1 Flexible conduit clamp
- 1 Cover plate
- 1 Magnetic Grille

1.855.663.5600 | www.soundtube.com

UL Listed 1480A & 2043

© 2024 SoundTube Entertainment, Inc. All rights reserved. PN 218-2131 | Rev 01.21.2025

Warning

SoundTube speakers must be installed by a professional audio installer/contractor. For safety and for optimum audio performance, installer must follow all directions issued by SoundTube Entertainment.

Warning

Do not spec or install speaker near support beam, ventilation duct or other structure that may interfere with speaker function or dispersion.

**CM-BGM-II-US Series
CI Series**

Drop Tile Install Instructions for:
CM52-BGM-II-US, CM52s-BGM-II-US, CM62-BGM-II-US, CM82-BGM-II-US
CI52, CI52s, and CI62

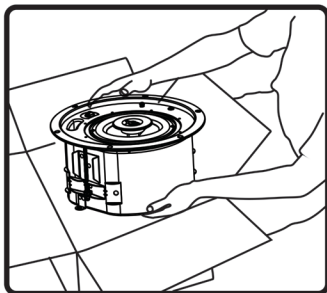

1. Unpack speaker & set aside grille assembly.

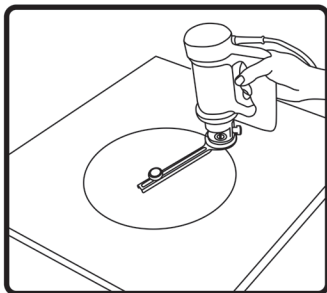

2. Use included tile bridge to mark a circle in the tile. Use Rotozip or other tool to cut hole, and remove cutout portion.

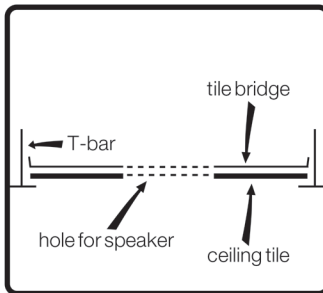

3. Place tile bridge into ceiling grid, then replace ceiling tile.

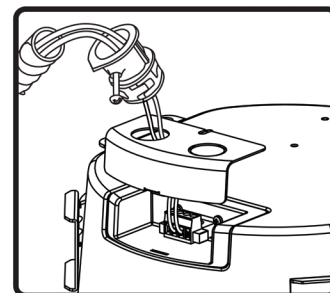

4. Run signal wires through conduit connector, then through cover plate.

Hole Diameters:
Standard BGM Models:
10.50 in / 266.7 mm
CI models:
9.125 in / 231.8 mm

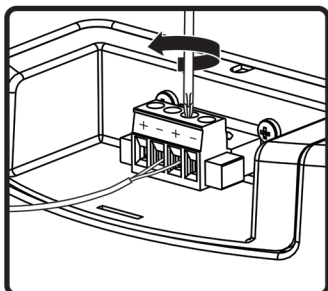

5. Connect to Euroblock connector. Two + and two - connectors are provided for daisy chaining.

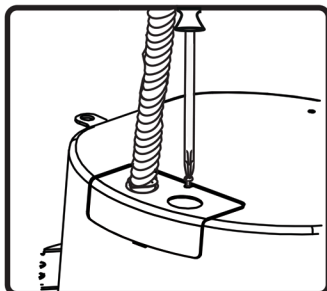

6. Tighten screw on terminal plate, and push conduit connector into knockout.

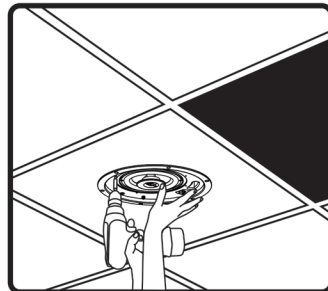

7. Insert speaker into mounting hole. Screw down both bolts on the baffle face to actuate the mounting wings. Firmly secure both bolts – do not over-tighten.

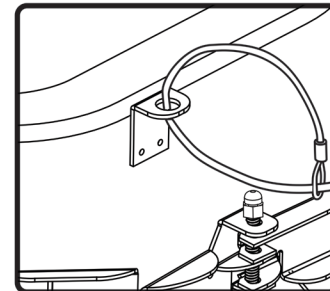

8. If required, a sheet-metal tab located on the rear panel of the speaker serves as a secondary point of attachment (cable not included).

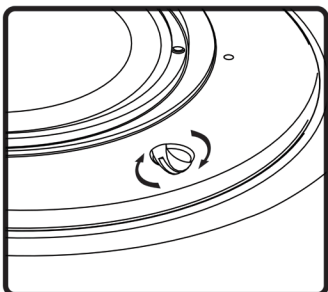

8. Select the tap position by adjusting rotary switch to desired high impedance value or voice coil direct mode.

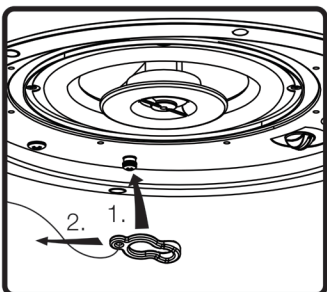

10. Attach grille safety clip by placing the large end of the clip over snap-fit post (1), then sliding clip until small end snaps into place around post (2).

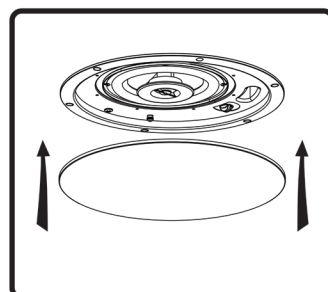

11. Place grille onto baffle. (The grille is held in place by magnets in the baffle.)

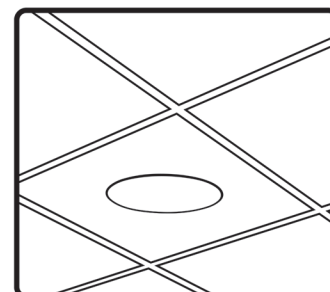

12. Done!

**CM-BGM-II-US Series
CI Series**

Sheetrock Install Instructions for:

CM52-BGM-II-US, CM52s-BGM-II-US, CM62-BGM-II-US, CM82-BGM-II-US
CI52, CI52s, and CI62

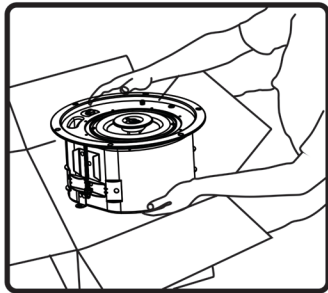

1. Unpack speaker & set aside grille assembly.

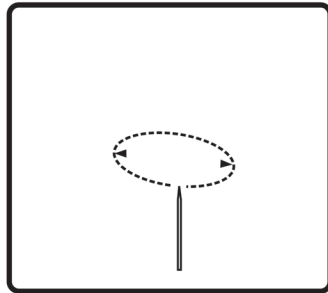

2. Mark cutout in finished sheetrock.

Hole Diameters:
Standard BGM Models:
10.50 in / 266.7 mm
CI models:
9.125 in / 231.8 mm

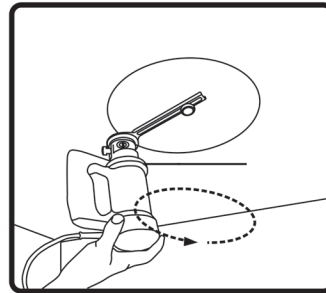

3. Use Rotozip or other tool to cut hole, and remove cutout portion.

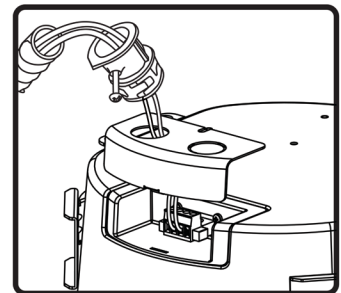

4. Run signal wires through conduit connector, then through cover plate. Connect to Euroblock connector.

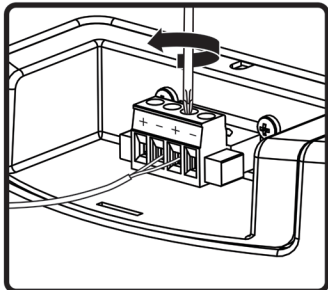

5. Connect to Euroblock connector. Two + and two - connectors are provided for daisy chaining.

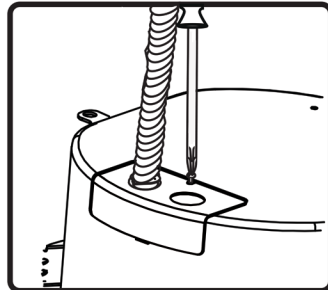

6. Tighten screw on terminal plate, and push conduit connector into knockout.



7. Insert speaker into mounting hole. Screw down both bolts on the baffle face to actuate the mounting wings. Firmly secure both bolts – do not over-tighten.

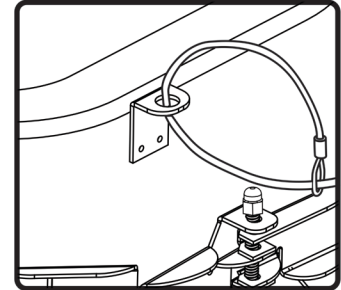

8. If required, a sheet-metal tab located on the rear panel of the speaker serves as a secondary point of attachment (cable not included).

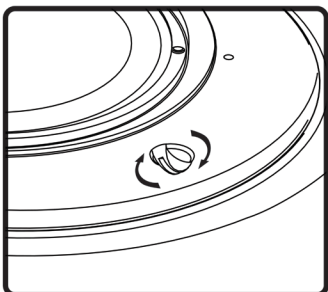

8. Select the tap position by adjusting rotary switch to desired high impedance value or voice coil direct mode.

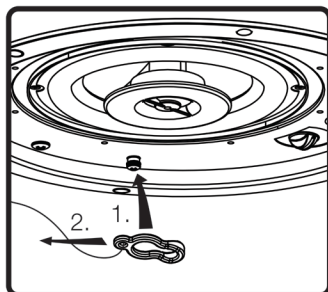

10. Attach grille safety clip by placing the large end of the clip over snap-fit post (1), then sliding clip until small end snaps into place around post (2).

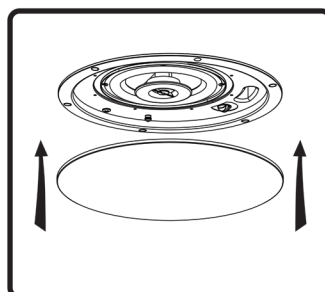

11. Place grille onto baffle. (The grille is held in place by magnets in the baffle.)

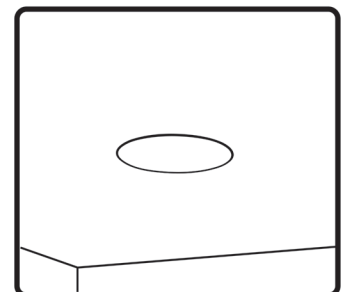

12. Done!

CM-BGM-II-US Series
CI Series

Preconstruction Install Instructions for:
CM52-BGM-II-US, CM52s-BGM-II-US, CM62-BGM-II-US, CM82-BGM-II-US
CI52, CI52s, and CI62

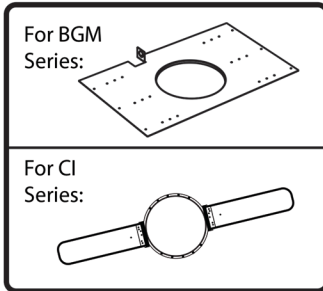

1. Nail or screw preconstruction bracket to joists. Secure conduit/signal wire away from hole in bracket.

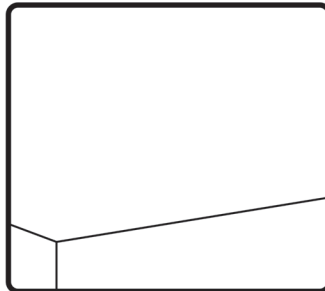

2. Complete Finish work on ceiling.

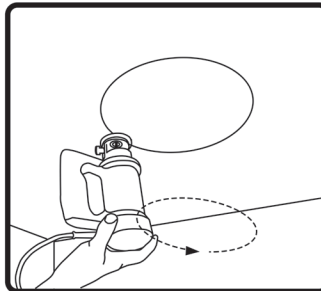

3. Mark cutout area, then use Rotozip or other tool to cut hole, and remove cutout portion.

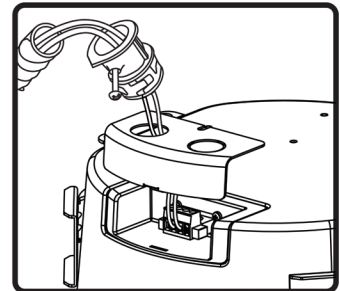

4. Run signal wires through conduit connector, then through cover plate. Connect to Euroblock connector.

Hole Diameters:
Standard BGM Models:
10.50 in / 266.7 mm
CI models:
9.125 in / 231.8 mm

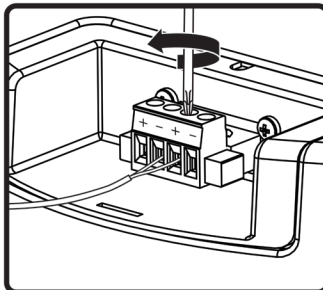

5. Connect to Euroblock connector. Two + and two - connectors are provided for daisy chaining.

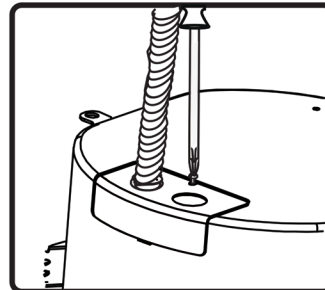

6. Tighten screw on terminal plate, and push conduit connector into knockout.

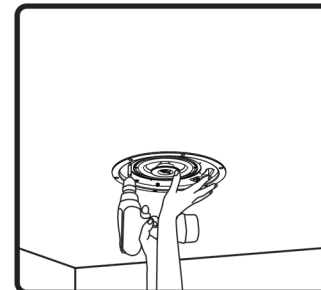

7. Insert speaker into mounting hole. Screw down both bolts on the baffle face to actuate the mounting wings. Firmly secure both bolts – do not over-tighten.

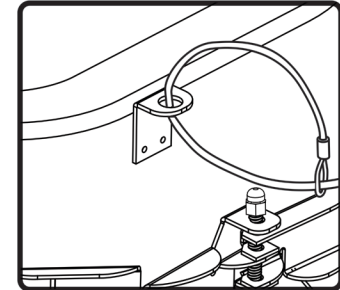

8. If required, a sheet-metal tab located on the rear panel of the speaker serves as a secondary point of attachment (cable not included).

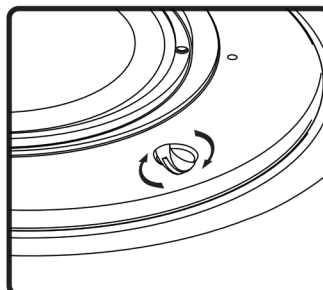

8. Select the tap position by adjusting rotary switch to desired high impedance value or voice coil direct mode.

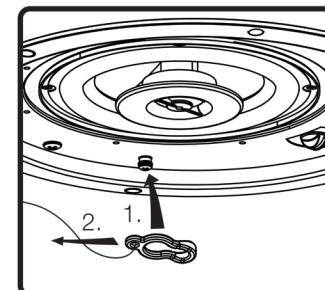

10. Attach grille safety clip by placing the large end of the clip over snap-fit post (1), then sliding clip until small end snaps into place around post (2).

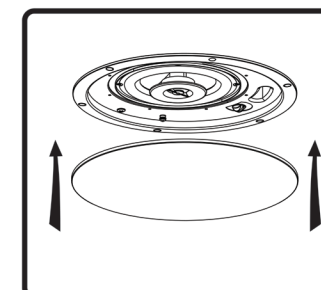

11. Place grille onto baffle. (The grille is held in place by magnets in the baffle.)

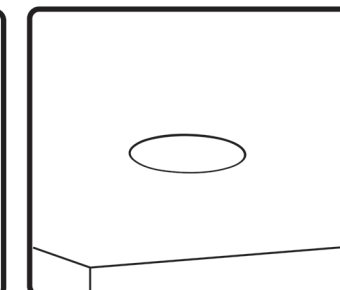

12. Done!